

Wi-Fi Enhancements Phase 2 Construction Authorization

Capital Project
CIP #C800585

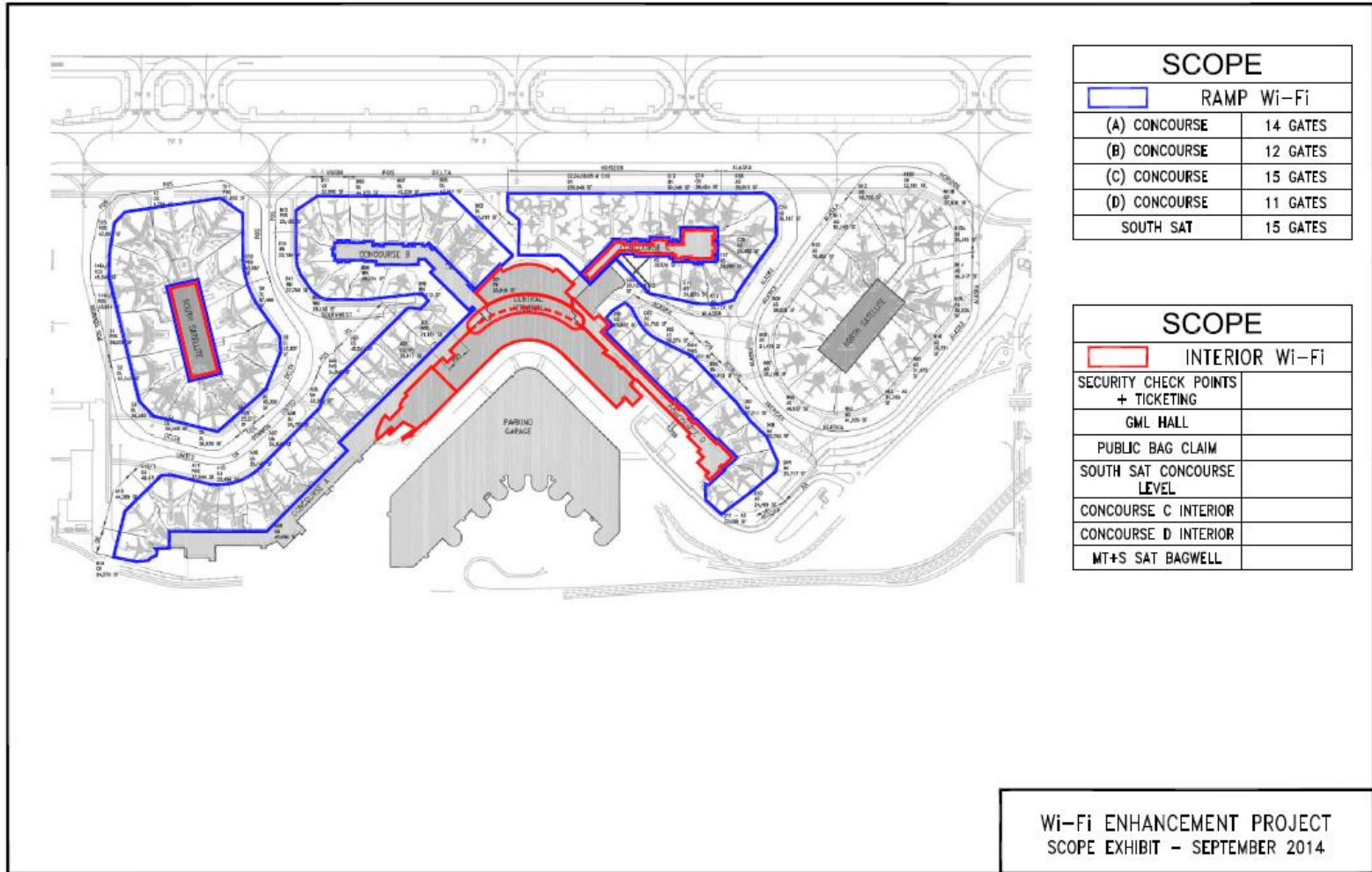

Project Scope



Phase 2 contains GML Hall, Baggage Claim, and the Bagwell

Terminal Wi-Fi Survey

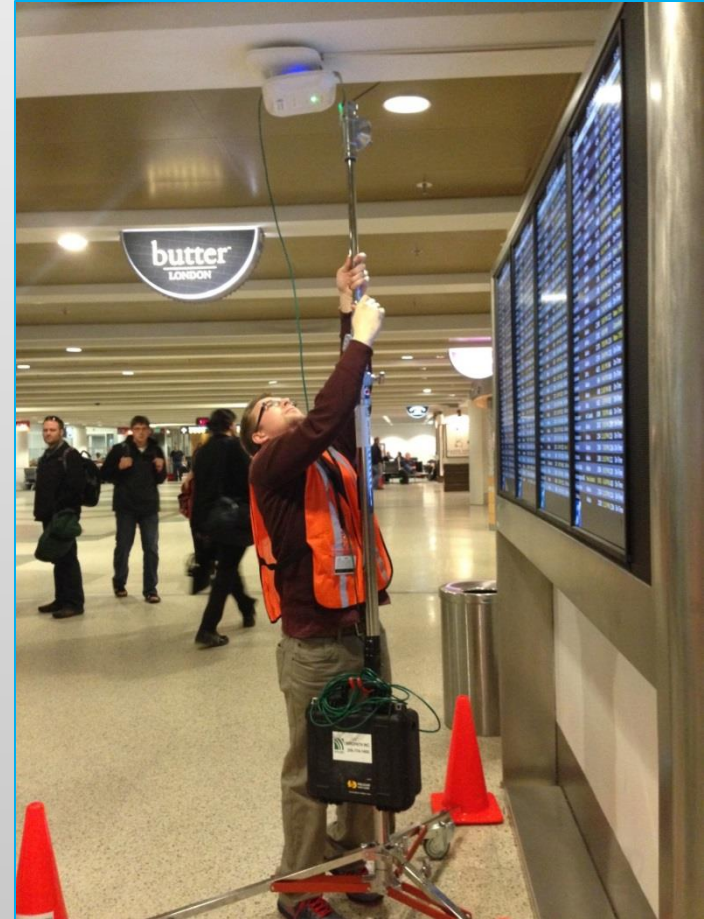
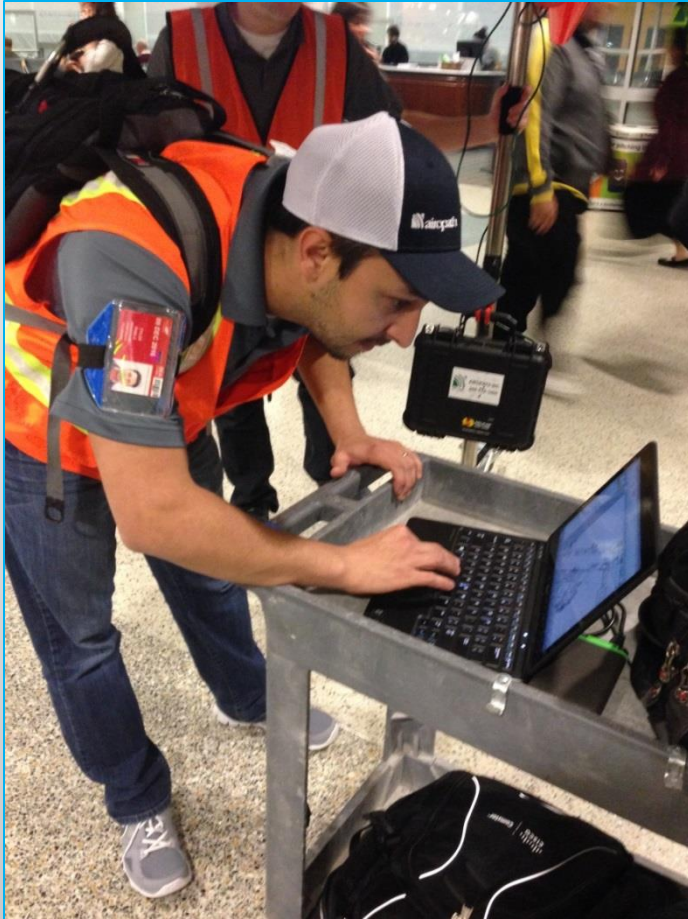

Survey team determining optimal position of Wi-Fi Access Points

Gina Marie Lindsey Hall



Proposed Wi-Fi Access Point

Questions?

Thank you

